

mansura

**"Gourmet Kitchen
22' Wide"**



**3 BED/ 2 BATH
1672 SQ. FT.
22' X 76'**

MODEL 22715

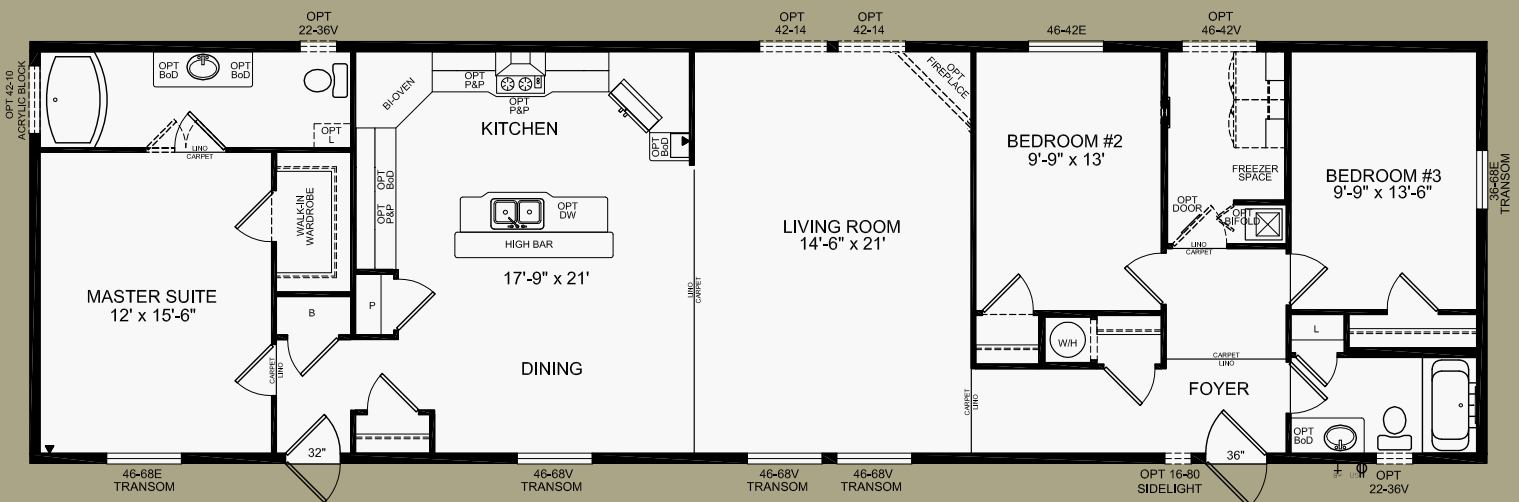

1421 Brier Park Crescent NW | Medicine Hat, AB T1C 1T8 | Phone: 403.527.1555 Fax: 403.528.4486
www.moduline.ca

Due to continuous product development and improvement, prices, specifications and materials are subject to change without notice or obligation. Square footage and other dimensions are approximate. Included renderings are artist renderings and are not intended to be an accurate representation of the home. Renderings and floor plans may be shown with optional features and/or third-party additions that may not be available in all regions or situations.

STANDARD FEATURES & SPECIFICATIONS

SPECIAL FEATURES

- Transom windows (white lattice incl)
- Chef’s island with sink
- Oval tub in ensuite
- Dressing table in ensuite
- Deluxe stainless steel range hood
- Cerantop cooktop & built-in oven (black)
- Stepped kitchen cabinets
- Decorative full height tile backsplash
- 19 cubic foot, 2-door, frost free refrigerator (black)
- Separate storage room

GENERAL CONSTRUCTION

- 8’ Ceilings
- Cathedral ceiling in living, dining area, and kitchen
- Maintenance free vinyl lap siding and metal fascia
- Fiberglass shingle roof (25 year)
- 16” Perimeter vented eaves (All 4 sides)
- Engineered open web truss floor @ 16” o.c. with heavy tubular steel frame
- 7/16” roof sheathing
- Engineered full 4-12 pitch roof trusses
- Textured (primed) gyproc ceiling
- Exterior walls built 2”x6” @ 16” o.c. strengthened with 3/8” OSB sheathing on inside and outside of wall
- 5/8” T & G OSB Floor Decking, glued and screwed
- Decorative insulated entry doors with dead bolt and peephole (36” front door)
- Coach lights at all exterior entrances
- Screen doors on front and rear entrances
- Residential maintenance free Low E PVC windows c/w vinyl sills, screens and security locks
- Exterior GFI electrical outlet and frost free water tap
- Insulation meets or exceeds codes
- Floors R-20, Walls R-20 & Ceiling R-40 (min)

TASTEFUL INTERIORS

- Plush Saxony carpet in living room, hall and all bedrooms
- Quality cushioned linoleum flooring all other areas (Selected by décor)
- Coordinating window valance over 2” white faux wood blinds (inset in window) in all areas except bathrooms
- Pre-finished interior passage doors

BRIGHT, BEAUTIFUL KITCHENS

- Double stainless steel sink
- Spacious pantry
- Doweled, full modular cabinetry w/crown moulding
- Three distinctive colors of cabinet doors to choose from

SPACIOUS BATHS

- One-piece quality fiberglass tub and shower units
- Curved Shower rods in all tubs
- Expansive vanity mirrors with Theatrical lights
- Deluxe tile backsplash
- GFI receptacle
- Power bath fan(s)
- Single lever faucet on tub/shower unit
- 36” vanity height in ensuite

UTILITY SERVICES

- 100 amp electrical panel
- High efficiency (90+AFUE) gas furnace with condensation pump
- 33 Imp. (40 US) gallon natural gas water heater
- Wired, plumbed and vented for washer and dryer
- Shelf above washer and dryer
- Primary exhaust fan c/w dehumidistat
- CO/Smoke Detector(s) c/w battery backup
- Dedicated GFI breaker and receptacle for heat tape
- Communication outlet (2) – Kitchen and Master Bedroom

